

# Broad delight

The renovation of a pre-war Brisbane cottage optimises a narrow block and opens up a new lifestyle for this young family.

STORY & STYLING KATE NIXON ♦ PHOTOGRAPHY MAREE HOMER



**COURTYARD** (this page and opposite) Young Harry and mum Kim relax in this breezy indoor-outdoor transition space. Custom dining table by Green Cathedral. Dining chairs, Viva Design Furniture. Marigold rug, Armadillo&Co. Throw, Country Road. Jill coffee table, Tait. Blue vase, Freedom. Cushions made up in outdoor textiles from Fab Outdoor Fabrics. Travertine tiles, Eco Outdoor. Flowers from Phoebe Stephens Flowers.  
**Designer buy:** Relax outdoor beanbag seats, \$605/each, Furniture Runway. For Where to Buy, see page 196.



*This is the life*

"We live on the lower level, with the living room and outdoor area acting as one whole room," says owner Kim Bridle. "When our families visit from the country there is plenty of space, and having our bedroom separate from the others gives us a lovely sense of privacy." Louvres carry breezes throughout the house in summer and skylights punctuate the spaces to draw in light throughout the year.



As owners of a construction company, Hugh and Kim Bridle were no strangers to new builds, but they had an itch to tackle an older, character home. In 2011 they found the ideal candidate in one of Brisbane's inner suburbs. "We'd been looking for about a year for a little cottage that we could renovate to achieve that combination of old and new," says Kim.

She and Hugh were fans of local architect Shaun Lockyer's work and brought him onto the project even before the keys were handed over. "As soon as we found this house, we knew he would be the man to transform it," says Kim. And so he did: the couple moved into the completed home 14 months after settlement with son Harry, now two, who now has a baby brother, six-month-old Thomas.

The pre-war cottage was positioned on a long, narrow and extremely steep block. "The house basically sat in a ditch and it was in a shocking state of disrepair," says Shaun. "All the original weatherboards had been covered with stucco and asbestos, the gables had been built out and the timber windows replaced with aluminium. Once we stripped back the post-war additions, the only discernible elements of the original cottage were a sleep-out verandah and four rooms on either side of the central hallway."

The ambitious transformation project involved raising the entire cottage, building a new entrance and double garage underneath, and making better use of the existing basement space. "We reinstated a lot of the detail that had been removed and then designed the new part of the house to take on its own character, shape, form and dimension," says Shaun. ➤

**'OUR PRIORITY WAS TO MAXIMISE CITY VIEWS AND HAVE ALL OUR LIVING SPACE ON ONE LEVEL.'** KIM

**KITCHEN** Blackbutt timber and richly veined stone add richness to a simple galley layout. Joinery by GW & DC Wathen. Corian benchtop in Glacier White. Splashback in Pietra Grey marble from Stone Galleria. Gaggenau wall oven. Modular pendant light, Light & Design Group. Replica Tractor stools, Sokol Designer Furniture. Flowers from Phoebe Stephens Flowers.

**DOWNSTAIRS LIVING** Powder-coated aluminium louvres are an eco-effective form of passive ventilation and temperature control. Sofa, Nick Scali. Fred coffee table and Archie armchair, Jardan. Cushions, Langdon LTD. Framed print, The Minimalist. Throw, Country Road. Louvres, Breezway.

**Designer buy:** Honeycomb cotton dhurrie rug, \$1170/1.8x2.4m, Fenton & Fenton.

For Where to Buy, see page 196.



FIRST FLOOR

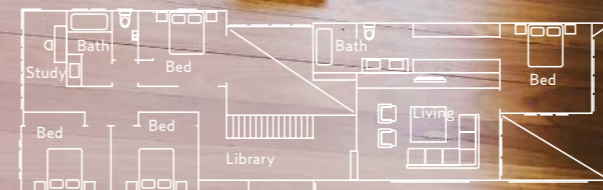

GROUND FLOOR

'THERE'S LOTS OF STORAGE THROUGHOUT THE HOUSE, WITH A LIBRARY UNDER THE STAIRCASE, CUSTOM-BUILT JOINERY IN BOTH OF THE LIVING AREAS AND STUDY DESKS BOTH UPSTAIRS AND DOWN!' SHAUN LOCKYER, ARCHITECT

**Open home**

A smooth connection between inside and out contributes to this home's easy ambience. "For Hugh and Kim, it was all about the family and the flow to the outside," says Shaun. His renovation plans included a transitional covered courtyard for living and dining, with a party-ready barbecue area, a swimming pool and an outdoor shower. The net effect is "a chilled holiday vibe", he says.



**MAIN BEDROOM** Bedlinen in gelato tones sits prettily in front of the warm blackbutt joinery. Bedcover, cushions and throw, all Country Road. Mak bedside lamp, Beacon Lighting. Flowers from Phoebe Stephens Flowers. **DINING** At the heart of the house is a dramatic double-height void. Chairs were a reconditioned roadside find. Custom table, Green Cathedral. Replica Monkey Boys pendant lights, Sokol Designer Furniture. **DINING** Black-stained oak veneer, dark marble and white Corian form a study in contrasts. Casa Lusso bath, Harvey Norman Commercial. **UPSTAIRS LIVING** Vista sofa, Jordan. Cowhide rug, Ikea. Hycraft Carramar carpet in Coal Ash, Godfrey Hirst Carpets. **Smart buy:** Stockholm nested tables in Oak, \$249/set of three, Freedom. For Where to Buy, see page 196.



Dulux Luck  
(exterior)

Dulux White On  
White (kitchen,  
main bedroom)

Dulux Dieskau  
(Harry's room)

ADD A DASH OF

Taubmans  
Frisolous

Touches of intense  
blue reference the  
heavenly hues of the  
pool and sunny skies.



“Everything was about taking full advantage of the width of the block and, at 10m, it feels incredibly generous,” he adds.

The entry hall now opens into a streamlined living/dining space, with a skylit, double-height void positioned directly over the dining table. “Ten or 15 years ago people would have put the dining table in the best room,” says Shaun. “Now, entertaining is more about gathering casually, which drove the idea of pulling the kitchen and living room towards the outdoor space and tucking the dining room back.” Upstairs, a library space and second living room separate the main suite from the other three bedrooms.

A lot of work was done to level the site and a retaining wall was built along the northern boundary to give privacy and focus on the city skyline view. The pool, a welcome addition in Brisbane’s climate, connects to the house through a double-height courtyard pavilion.

“Our priority was to maximise the city view and have all our living on one level,” says Kim. “We wanted to create that indoor-outdoor feel and good light throughout, which Shaun did beautifully.”

A palette of New Guinea rosewood, blackbutt and oak veneer, dark brick and black japan melds old with new, and provides a solid background for Kim’s aesthetic touches. “I was keen to add a bit of colour, to soften and balance the strength of the architecture,” she says. “I love Danish design and clean, contemporary living. We have two little hazards now, so it’s all about keeping things simple.” **H&G**

**Architect:** Shaun Lockyer Architects, Fortitude Valley, Queensland; (07) 3257 7288 or [www.lockyerarchitects.com.au](http://www.lockyerarchitects.com.au). **Builder:** Kalka, Paddington, Queensland; (07) 3368 2016 or [www.kalka.com.au](http://www.kalka.com.au).

Paint colours are reproduced as accurately as printing processes allow.

‘SHAUN WAS ABLE TO GIVE US PRIVACY ON THIS INNER-CITY BLOCK.’ KIM

**HARRY'S ROOM** Small-scale furniture fosters self-sufficiency. Chest of drawers, Ikea. Replica Eames DSW chair, Sokol Designer Furniture. Leal lampshade, Freedom. Print, Printsplace.

**Smart buy:** Sorbet Balloon cushion, \$90, The Dan300 Group.

**POOL** Leafy green views and lush plantings, including variegated mother-in-law’s tongue (*Sansevieria trifasciata*, left), break up the clean planes. MissoniHome towels, Olive Home. Shower, Oz Bathrooms.

**EXTERIOR** “The back elevation is something I really love about this house,” says Shaun. “The fact that the clients embraced it and executed it so superbly was a real joy.” Primeline Newport weatherboard, James Hardie. Bricks in Precision Black, Austral Bricks. **For Where to Buy, see page 196.**